

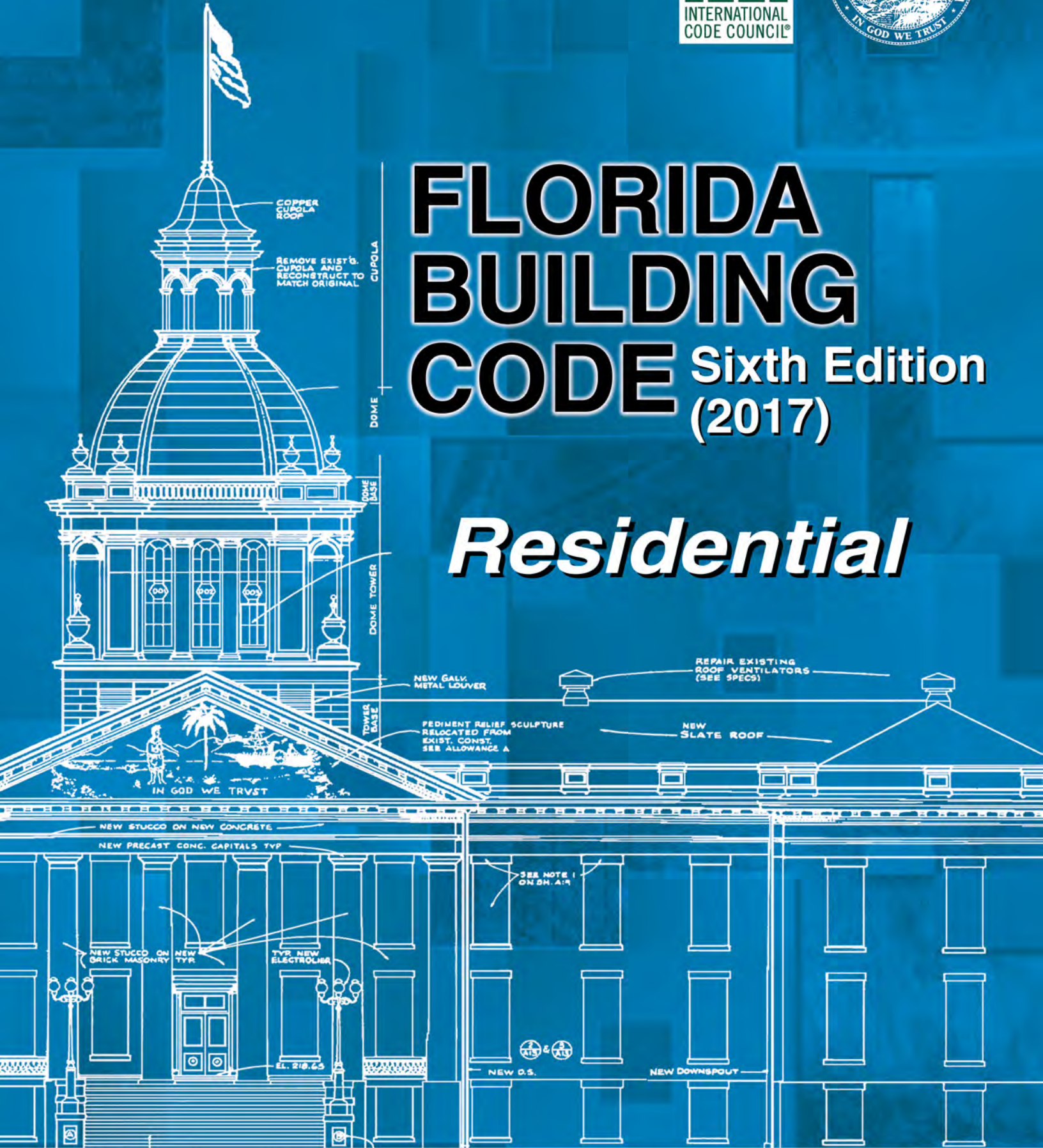

FLORIDA BUILDING CODE

Sixth Edition (2017)

Residential



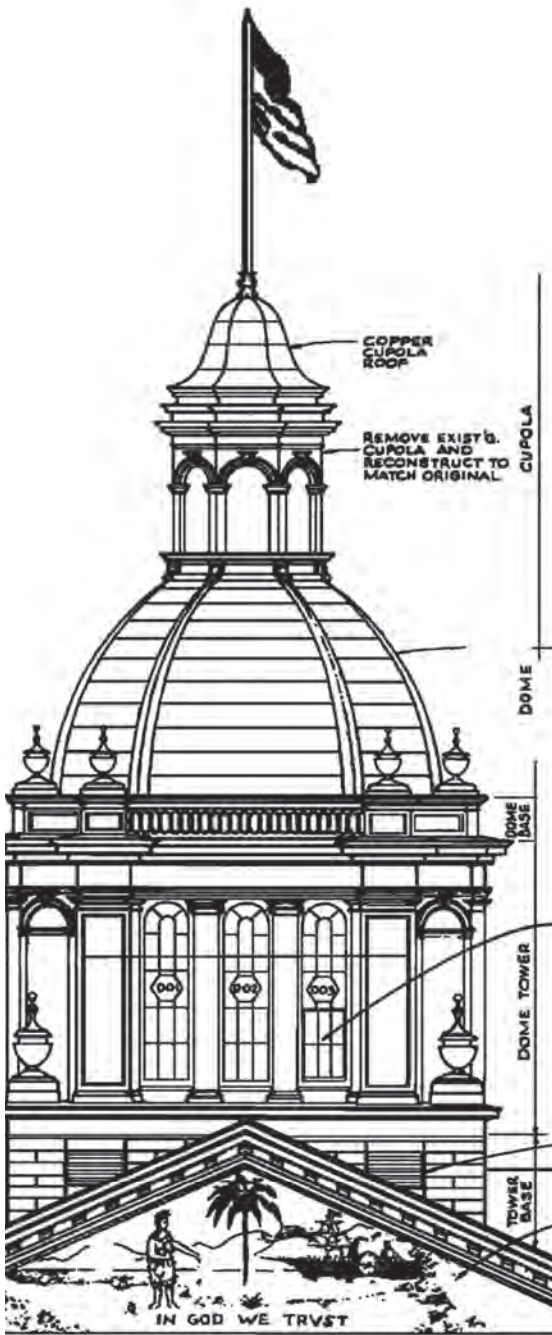

FLORIDA BUILDING CODE

Sixth Edition
(2017)

Residential

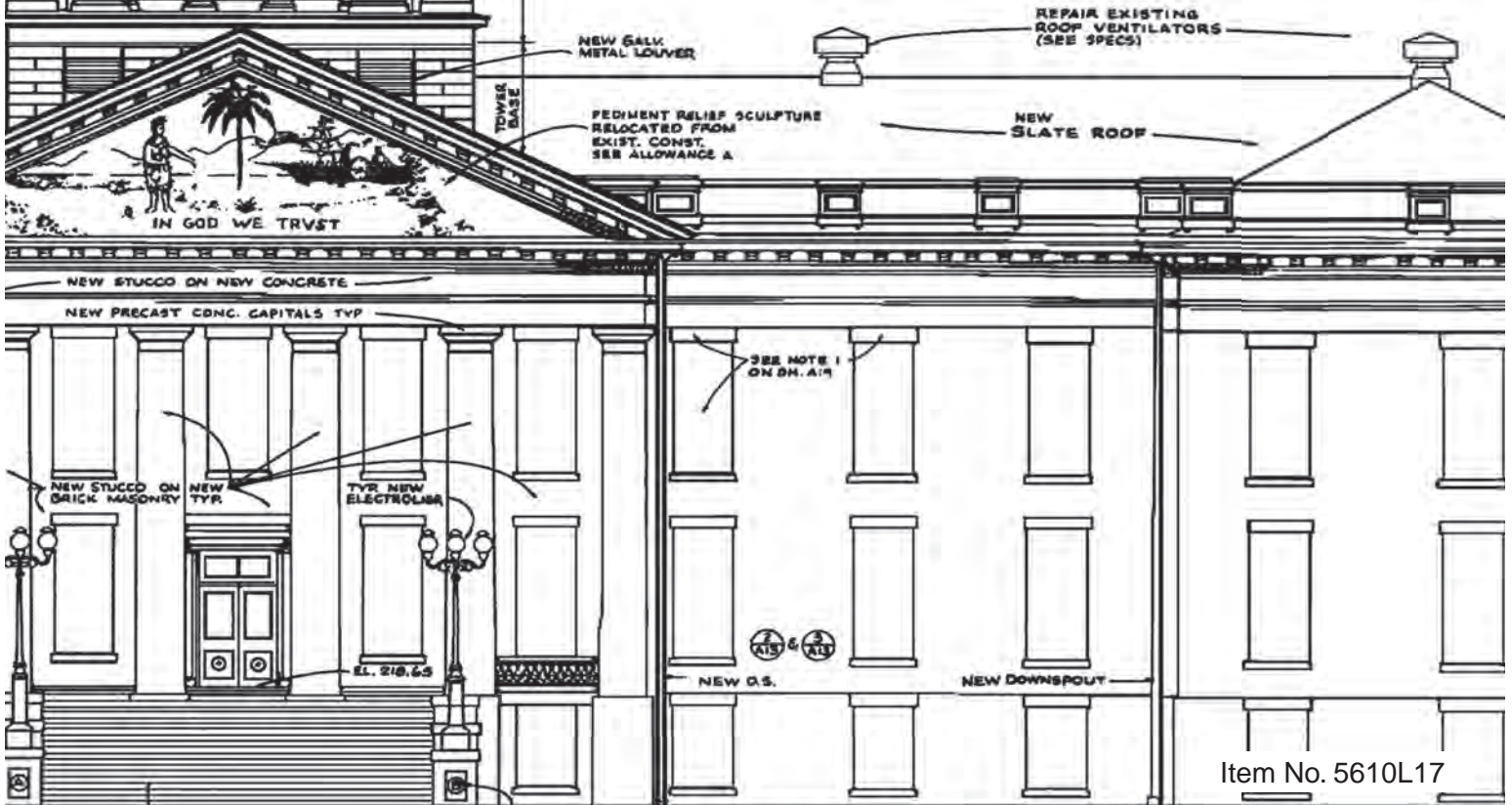

Florida Building Code, Residential, 6th Edition (2017)

First Printing: July 2017

ISBN: 978-1-60983-692-4

COPYRIGHT © 2017
by
INTERNATIONAL CODE COUNCIL, INC.

ALL RIGHTS RESERVED. This *Florida Building Code, Residential, 6th Edition (2017)* contains substantial copyrighted materials from the 2015 *International Residential Code*[®], 2nd printing, which is a copyrighted work owned by the International Code Council, Inc., that is © 2015 International Code Council, Inc. ALL RIGHTS RESERVED. Without advance written permission from the copyright owner, no part of this work may be reproduced, distributed or transmitted in any form or by any means, including, without limitation, electronic, optical or mechanical means (by way of example, and not limitation, photocopying, or recording by or in an information storage retrieval system). For information on use rights and permissions, please contact: Publications, 4051 Flossmoor Road, Country Club Hills, IL 60478. Phone 1-888-ICC-SAFE (422-7233).

The following trademarks: “International Code Council,” the “International Code Council” logo, “ICC,” the “ICC” logo, the “International Residential Code,” and the “IRC” are trademarks of the International Code Council, Inc., and may not be used without permission.

PRINTED IN THE U.S.A

PREFACE

History

The State of Florida first mandated statewide building codes during the 1970s at the beginning of the modern construction boom. The first law required all municipalities and counties to adopt and enforce one of the four state-recognized model codes known as the “state minimum building codes.” During the early 1990s a series of natural disasters, together with the increasing complexity of building construction regulation in vastly changed markets, led to a comprehensive review of the state building code system. The study revealed that building code adoption and enforcement was inconsistent throughout the state and those local codes thought to be the strongest proved inadequate when tested by major hurricane events. The consequences of the building codes system failure were devastation to lives and economies and a statewide property insurance crisis. The response was a reform of the state building construction regulatory system that placed emphasis on uniformity and accountability.

The 1998 Florida Legislature amended Chapter 553, *Florida Statutes* (FS), Building Construction Standards, to create a single state building code that is enforced by local governments. As of March 1, 2002, the *Florida Building Code*, which is developed and maintained by the Florida Building Commission, supersedes all local building codes. The *Florida Building Code* is updated every three years and may be amended annually to incorporate interpretations and clarifications.

Scope

The *Florida Building Code* is based on national model building codes and national consensus standards which are amended where necessary for Florida’s specific needs. The code incorporates all building construction-related regulations for public and private buildings in the State of Florida other than those specifically exempted by Section 553.73, *Florida Statutes*. It has been harmonized with the *Florida Fire Prevention Code*, which is developed and maintained by the Department of Financial Services, Office of the State Fire Marshal, to establish unified and consistent standards.

The base codes for the *Florida Building Code*, 6th Edition (2017) include: the 2015 editions of the *International Building Code*®; the *International Plumbing Code*®; the *International Mechanical Code*®; the *International Fuel Gas Code*®; the *International Residential Code*®; the *International Existing Building Code*®; the *International Energy Conservation Code*®; the *National Electrical Code*, 2014 edition; or substantive criteria from ASHRAE Standard 90.1-2013. State and local codes adopted and incorporated into the code include the *Florida Building Code, Accessibility*, and special hurricane protection standards for the High-Velocity Hurricane Zone.

The code is composed of nine main volumes: the *Florida Building Code, Building*, which also includes state regulations for licensed facilities; the *Florida Building Code, Plumbing*; the *Florida Building Code, Mechanical*; the *Florida Building Code, Fuel Gas*; the *Florida Building Code, Existing Building*; the *Florida Building Code, Residential*; the *Florida Building Code, Energy Conservation*; the *Florida Building Code, Accessibility* and the *Florida Building Code, Test Protocols for High-Velocity Hurricane Zones*. Chapter 27 of the *Florida Building Code, Building*, adopts the *National Electrical Code*, NFPA 70, by reference.

Under certain strictly defined conditions, local governments may amend requirements to be more stringent than the code. All local amendments to the *Florida Building Code* must be adopted by local ordinance and reported to the Florida Building Commission then posted on www.florida-building.org in Legislative format for a month before being enforced. Local amendments to the *Florida Building Code* and the *Florida Fire Prevention Code* may be obtained from the Florida Building Commission web site, or from the Florida Department of Business and Professional Regulation or the Florida Department of Financial Services, Office of the State Fire Marshal, respectively.

Adoption and Maintenance

The *Florida Building Code* is adopted and updated with new editions triennially by the Florida Building Commission. It is amended annually to incorporate interpretations, clarifications and to update standards. Minimum requirements for permitting, plans review and inspections are established by the code, and local jurisdictions may adopt additional administrative requirements that are more stringent. Local technical amendments are subject to strict criteria established by Section 553.73, FS. They are subject to Commission review and adoption into the code or repeal when the code is updated triennially and are subject to appeal to the Commission according to the procedures established by Section 553.73, FS.

Eleven Technical Advisory Committees (TACs), which are constituted consistent with American National Standards Institute (ANSI) Guidelines, review proposed code changes and clarifications of the code and make recommendations to the Commission. These TACs whose membership is constituted consistent with American National Standards Institute (ANSI) Guidelines include: Accessibility; Joint Building Fire (a joint committee of the Commission and the State Fire Marshal); Building Structural; Code Administration/ Enforcement; Electrical; Energy; Mechanical; Plumbing and Fuel Gas; Roofing; Swimming Pool; and Special Occupancy (state agency construction and facility licensing regulations).

The Commission may only issue official code clarifications using procedures of Chapter 120, *Florida Statutes*. To obtain such a clarification, a request for a Declaratory Statement (DEC) must be made to the Florida Building Commission in a manner that establishes a clear set of facts and circumstances and identifies the section of the code in question. Requests are analyzed by staff, reviewed by the appropriate Technical Advisory Committee, and sent to the Florida Building Commission for action. These interpretations establish precedents for situations having similar facts and circumstances and are typically incorporated into the code in the next code amendment cycle. Non-binding opinions are available from the Building Officials Association of Florida's web site (www.BOAF.net) and a Binding Opinion process is available online at www.floridabuilding.org.

Code Development Committee Responsibilities

In each code development cycle, proposed changes to the code are considered at the Committee Action Hearings by the applicable International Code Development Committee as follows:

[RB] = IRC—Building Code Development Committee

[RE] = Residential Energy Code Development Committee

[RMP] = IRC—Mechanical/Plumbing Code Development Committee

The [RE] committee is also responsible for the IECC—Residential Provisions.

Marginal Markings

Solid vertical lines in the margins within the body of the code indicate a technical change from the requirements of the 2012 edition. Deletion indicators in the form of an arrow (➡) are provided in the margin where an entire section, paragraph, exception or table has been deleted or an item in a list of items or a table has been deleted.

A single asterisk [*] placed in the margin indicates that text or a table has been relocated within the code. A double asterisk [**] placed in the margin indicates that the text or table immediately following it has been relocated there from elsewhere in the code.

Dotted vertical lines in the margins within the body of the code indicate a change from the requirements of the base codes to the *Florida Building Code, Residential*, 6th Edition (2017) effective December 31, 2017.

Sections deleted from the base code are designated “Reserved” in order to maintain the structure of the base code.

Italicized Terms

Selected terms set forth in Chapter 2, Definitions, are italicized where they appear in code text. Such terms are not italicized where the definition set forth in Chapter 2 does not impart the intended meaning in the use of the term. The terms selected have definitions that the user should read carefully to better understand the code.

Acknowledgments

The *Florida Building Code* is produced through the efforts and contributions of building designers, contractors, product manufacturers, regulators and other interested parties who participate in the Florida Building Commission’s consensus processes, Commission staff and the participants in the national model code development processes.

TABLE OF CONTENTS

<p><i>Part I—Administrative</i> 1</p> <p>CHAPTER 1 SCOPE AND ADMINISTRATION 1</p> <p>PART 1—SCOPE AND APPLICATION 1</p> <p>Section</p> <p>R101 General 1</p> <p>R102 Applicability (Reserved) 1</p> <p>PART 2—ADMINISTRATION AND ENFORCEMENT 1</p> <p>Section</p> <p>R103 Department of Building Safety (Reserved) 1</p> <p>R104 Duties and Powers of the Building Official (Reserved) 1</p> <p>R105 Permits (Reserved) 1</p> <p>R106 Construction Documents (Reserved) 1</p> <p>R107 Temporary Structures and Uses (Reserved) 1</p> <p>R108 Fees (Reserved) 1</p> <p>R109 Inspections (Reserved) 1</p> <p>R110 Certificate of Occupancy (Reserved) 1</p> <p>R111 Service Utilities (Reserved) 1</p> <p>R112 Board of Appeals (Reserved) 2</p> <p>R113 Violations (Reserved) 2</p> <p>R114 Stop Work Order (Reserved) 2</p> <p><i>Part II—Definitions</i> 3</p> <p>CHAPTER 2 DEFINITIONS 3</p> <p>Section</p> <p>R201 General 3</p> <p>R202 Definitions 3</p> <p><i>Part III—Building Planning and Construction</i> 21</p> <p>CHAPTER 3 BUILDING PLANNING 21</p> <p>Section</p> <p>R301 Design Criteria 21</p> <p>R302 Fire-resistant Construction 46</p> <p>R303 Light, Ventilation and Heating 51</p> <p>R304 Minimum Room Areas 52</p> <p>R305 Ceiling Height 52</p>	<p>R306 Sanitation 52</p> <p>R307 Toilet, Bath and Shower Spaces 52</p> <p>R308 Glazing 53</p> <p>R309 Garages and Carports 57</p> <p>R310 Emergency Escape and Rescue Openings 57</p> <p>R311 Means of Egress 58</p> <p>R312 Guards and Window Fall Protection 62</p> <p>R313 Automatic Fire Sprinkler Systems (Reserved) 62</p> <p>R314 Smoke Alarms 62</p> <p>R315 Carbon Monoxide Alarms 63</p> <p>R316 Foam Plastic 64</p> <p>R317 Protection of Wood and Wood-based Products against Decay 65</p> <p>R318 Protection against Termites 67</p> <p>R319 Site Address 69</p> <p>R320 Accessibility 69</p> <p>R321 Elevators and Platform Lifts 69</p> <p>R322 Flood-resistant Construction 70</p> <p>R323 Storm Shelters 73</p> <p>R324 Solar Energy Systems 73</p> <p>R325 Mezzanines 74</p> <p>R326 Swimming Pools, Spas and Hot Tubs 74</p> <p>R327 Airport Noise 74</p> <p>CHAPTER 4 FOUNDATIONS 75</p> <p>Section</p> <p>R401 General 75</p> <p>R402 Materials 78</p> <p>R403 Footings 78</p> <p>R404 Foundation and Retaining Walls 94</p> <p>R405 Foundation Drainage 122</p> <p>R406 Foundation Waterproofing and Dampproofing 123</p> <p>R407 Columns 124</p> <p>R408 Under-floor Space 124</p> <p>CHAPTER 5 FLOORS 127</p> <p>Section</p> <p>R501 General 127</p> <p>R502 Wood Floor Framing 127</p> <p>R503 Floor Sheathing 136</p>
--	--

TABLE OF CONTENTS

R504 Pressure Preservative-treated Wood Floors (On Ground) 137

R505 Cold-formed Steel Floor Framing 138

R506 Concrete Floors (On Ground). 153

R507 Exterior Decks 153

CHAPTER 6 WALL CONSTRUCTION 161

Section

R601 General 161

R602 Wood Wall Framing 161

R603 Cold-formed Steel Wall Framing 207

R604 Wood Structural Panels 248

R605 Particleboard 248

R606 General Masonry Construction 248

R607 Glass Unit Masonry 261

R608 Exterior Concrete Wall Construction 262

R609 Exterior Windows and Doors 332

R610 Structural Insulated Panel Wall Construction 337

CHAPTER 7 WALL COVERING 349

Section

R701 General 349

R702 Interior Covering 349

R703 Exterior Covering 353

CHAPTER 8 ROOF-CEILING CONSTRUCTION 373

Section

R801 General 373

R802 Wood Roof Framing 373

R803 Roof Sheathing 401

R804 Cold-formed Steel Roof Framing 402

R805 Ceiling Finishes 416

R806 Roof Ventilation 418

R807 Attic Access 419

CHAPTER 9 ROOF ASSEMBLIES 421

Section

R901 General 421

R902 Fire Classification 421

R903 Weather Protection 421

R904 Materials 422

R905 Requirements for Roof Coverings 422

R906 Roof Insulation 431

R907 Rooftop-mounted Photovoltaic Systems 431

R908 Existing Roofing 431

R909 Rooftop-mounted Photovoltaic Panel Systems 435

CHAPTER 10 CHIMNEYS AND FIREPLACES . . . 437

Section

R1001 Masonry Fireplaces 437

R1002 Masonry Heaters 441

R1003 Masonry Chimneys 441

R1004 Factory-built Fireplaces 445

R1005 Factory-built Chimneys 446

R1006 Exterior Air Supply 446

Part IV—Energy Conservation 447

CHAPTER 11 [RE] ENERGY EFFICIENCY 447

Section

N1101 General 447

Part V—Mechanical 449

CHAPTER 12 MECHANICAL ADMINISTRATION 449

Section

M1201 General 449

M1202 Existing Mechanical Systems 449

CHAPTER 13 GENERAL MECHANICAL SYSTEM REQUIREMENTS 451

Section

M1301 General 451

M1302 Approval 451

M1303 Labeling of Appliances 451

M1304 Type of Fuel 451

M1305 Appliance Access 451

M1306 Clearances from Combustible Construction 452

M1307 Appliance Installation 453

M1308 Mechanical Systems Installation 456

CHAPTER 14 HEATING AND COOLING EQUIPMENT AND APPLIANCES 457

Section

M1401 General 457

M1402 Central Furnaces 457

M1403 Heat Pump Equipment 457

M1404 Refrigeration Cooling Equipment 457

M1405 Baseboard Convectors 457

M1406 Radiant Heating Systems 457

M1407 Duct Heaters 458

M1408 Vented Floor Furnaces 458

M1409 Vented Wall Furnaces 459

M1410 Vented Room Heaters 459

M1411 Heating and Cooling Equipment 459

M1412 Absorption Cooling Equipment 460

M1413 Evaporative Cooling Equipment 460

M1414 Fireplace Stoves 461

M1415 Masonry Heaters 461

CHAPTER 15 EXHAUST SYSTEMS 463

Section

M1501 General 463

M1502 Clothes Dryer Exhaust 463

M1503 Range Hoods 464

M1504 Installation of Microwave Ovens 465

M1505 Overhead Exhaust Hoods 465

M1506 Exhaust Ducts and Exhaust Openings 465

M1507 Mechanical Ventilation 465

CHAPTER 16 DUCT SYSTEMS 467

Section

M1601 Duct Construction 467

M1602 Return Air 470

CHAPTER 17 COMBUSTION AIR 471

Section

M1701 General 471

CHAPTER 18 CHIMNEYS AND VENTS 473

Section

M1801 General 473

M1802 Vent Components 473

M1803 Chimney and Vent Connectors 474

M1804 Vents 475

M1805 Masonry and Factory-built Chimneys 475

**CHAPTER 19 SPECIAL APPLIANCES,
EQUIPMENT AND SYSTEMS 477**

Section

M1901 Ranges and Ovens 477

M1902 Sauna Heaters 477

M1903 Stationary Fuel Cell Power Plants 477

M1904 Gaseous Hydrogen Systems 477

**CHAPTER 20 BOILERS AND
WATER HEATERS 479**

Section

M2001 Boilers 479

M2002 Operating and Safety Controls 479

M2003 Expansion Tanks 479

M2004 Water Heaters Used for Space Heating 480

M2005 Water Heaters 480

M2006 Pool Heaters 480

CHAPTER 21 HYDRONIC PIPING 481

Section

M2101 Hydronic Piping Systems Installation 481

M2102 Baseboard Convectors 481

M2103 Floor Heating Systems 481

M2104 Low Temperature Piping 483

M2105 Ground-Source Heat-Pump System
Loop Piping 483

**CHAPTER 22 SPECIAL PIPING AND
STORAGE SYSTEMS 487**

Section

M2201 Oil Tanks 487

M2202 Oil Piping, Fitting and Connections 487

M2203 Installation 487

M2204 Oil Pumps and Valves 488

**CHAPTER 23 SOLAR THERMAL
ENERGY SYSTEMS 489**

Section

M2301 Thermal Solar Energy Systems 489

Part VI—Fuel Gas 491

CHAPTER 24 FUEL GAS 491

Section

G2401 General 491

G2402 General 491

G2403 General Definitions 491

G2404 General 497

G2405 Structural Safety 498

G2406 Appliance Location 498

G2407 Combustion, Ventilation and Dilution Air 499

G2408 Installation 503

G2409 Clearance Reduction 503

G2410 Electrical 506

TABLE OF CONTENTS

G2411	Electrical Bonding	507	G2451	Infrared Radiant Heaters	568
G2412	General	507	G2452	Boilers	568
G2413	Pipe Sizing	507	G2453	Chimney Damper Opening Area	568
G2414	Piping Materials	529	G2454	Outdoor Decorative Appliances	568
G2415	Piping System Installation	531	Part VII—Plumbing 569		
G2416	Piping Bends and Changes in Direction	533	CHAPTER 25 PLUMBING		
G2417	Inspection, Testing and Purging	534	ADMINISTRATION 569		
G2418	Piping Support	536	Section		
G2419	Drips and Sloped Piping	536	P2501	General	569
G2420	Shutoff Valves	537	P2502	Existing Plumbing Systems	569
G2421	Flow Controls	537	P2503	Inspection and Tests	569
G2422	Appliance Connections	538	CHAPTER 26 GENERAL PLUMBING		
G2423	Compressed Natural Gas Motor Vehicle Fuel-dispensing Facilities	539	REQUIREMENTS 571		
G2424	Piping Support Intervals	539	Section		
G2425	General	539	P2601	General	571
G2426	Vents	541	P2602	Individual Water Supply and Sewage Disposal	571
G2427	Venting of Appliances	541	P2603	Structural and Piping Protection	571
G2428	Sizing of Category I Appliance Venting Systems	550	P2604	Trenching and Backfilling	572
G2429	Direct-vent, Integral Vent, Mechanical Vent and Ventilation/Exhaust Hood Venting	562	P2605	Support	572
G2430	Factory-built Chimneys	562	P2606	Penetrations	573
G2431	General	562	P2607	Waterproofing of Openings	573
G2432	Decorative Appliances for Installation in Fireplaces	562	P2608	Workmanship	573
G2433	Log Lighters	562	P2609	Materials Evaluation and Listing	573
G2434	Vented Gas Fireplaces (Decorative Appliances)	562	CHAPTER 27 PLUMBING FIXTURES 575		
G2435	Vented Gas Fireplace Heaters	562	Section		
G2436	Vented Wall Furnaces	562	P2701	Fixtures, Faucets and Fixture Fittings	575
G2437	Floor Furnaces	563	P2702	Fixture Accessories	575
G2438	Clothes Dryers	563	P2703	Tail Pieces	575
G2439	Clothes Dryer Exhaust	563	P2704	Access to Connections	575
G2440	Sauna Heaters	564	P2705	Installation	575
G2441	Pool and Spa Heaters	565	P2706	Waste Receptors	575
G2442	Forced-air Warm-air Furnaces	565	P2707	Directional Fittings	577
G2443	Conversion Burners	566	P2708	Showers	577
G2444	Unit Heaters	566	P2709	Shower Receptors	577
G2445	Unvented Room Heaters	566	P2710	Shower Walls	578
G2446	Vented Room Heaters	567	P2711	Lavatories	578
G2447	Cooking Appliances	567	P2712	Water Closets	578
G2448	Water Heaters	567	P2713	Bathtubs	579
G2449	Air-Conditioning Appliances	567	P2714	Sinks	579
G2450	Illuminating Appliances	567	P2715	Laundry Tubs	579
			P2716	Food-waste Disposer	579

P2717	Dishwashing Machines	579	P3007	Sumps and Ejectors	623
P2718	Clothes Washing Machine	579	P3008	Backwater Valves	624
P2719	Floor Drains	579	P3009	Subsurface Landscape Irrigation Systems	624
P2720	Whirlpool Bathtubs	579	P3010	Replacement of Underground Sewers by Pipe Bursting Methods	626
P2721	Bidet Installations	580			
P2722	Fixture Fitting	580	CHAPTER 31 VENTS	627	
P2723	Macerating Toilet Systems	580	Section		
P2724	Speciality Temperature Control Devices and Valves	580	P3101	Vent Systems	627
P2725	Nonliquid Saturated Treatment Systems	580	P3102	Vent Stacks and Stack Vents	627
			P3103	Vent Terminals	627
CHAPTER 28 WATER HEATERS	581		P3104	Vent Connections and Grades	627
Section			P3105	Fixture Vents	628
P2801	General	581	P3106	Individual Vent	628
P2802	Solar Water Heating Systems	581	P3107	Common Vent	628
P2803	Water Heaters Used for Space Heating	581	P3108	Wet Venting	628
P2804	Relief Valves	582	P3109	Waste Stack Vent	629
			P3110	Circuit Venting	629
CHAPTER 29 WATER SUPPLY AND DISTRIBUTION	583		P3111	Combination Waste and Vent System	629
Section			P3112	Island Fixture Venting	630
P2901	General	583	P3113	Vent Pipe Sizing	630
P2902	Protection of Potable Water Supply	583	P3114	Air Admittance Valves	630
P2903	Water Supply System	586			
P2904	Dwelling Unit Fire Sprinkler Systems	590	CHAPTER 32 TRAPS	633	
P2905	Heated Water Distribution Systems	602	Section		
P2906	Materials, Joints and Connections	602	P3201	Fixture Traps	633
P2907	Changes in Direction	606			
P2908	Support	606	CHAPTER 33 STORM DRAINAGE	635	
P2909	Drinking Water Treatment Units	606	Section		
P2910	Nonpotable Water Systems	606	P3301	General	635
P2911	On-site Nonpotable Water Reuse Systems	609	P3302	Subsoil Drains	635
P2912	Nonpotable Rainwater Collection and Distribution Systems	611	P3303	Sumps and Pumping Systems	635
P2913	Reclaimed Water Systems	613			
			Part VIII—Electrical	637	
CHAPTER 30 SANITARY DRAINAGE	615		CHAPTER 34 GENERAL REQUIREMENTS	637	
Section			Section		
P3001	General	615	E3401	General	637
P3002	Materials	615	E3402	Building Structure Protection	638
P3003	Joints and Connections	617	E3403	Inspection and Approval	638
P3004	Determining Drainage Fixture Units	619	E3404	General Equipment Requirements	638
P3005	Drainage System	619	E3405	Equipment Location and Clearances	640
P3006	Sizing of Drain Pipe Offsets	623	E3406	Electrical Conductors and Connections	640
			E3407	Conductor and Terminal Identification	643

TABLE OF CONTENTS

CHAPTER 35 ELECTRICAL DEFINITIONS 645

Section
E3501 General 645

CHAPTER 36 SERVICES 651

Section
E3601 General Services 651
E3602 Service Size and Rating 651
E3603 Service, Feeder and Grounding
Electrode Conductor Sizing 652
E3604 Overhead Service and Service-entrance
Conductor Installation 653
E3605 Service-entrance Conductors 655
E3606 Service Equipment—General 655
E3607 System Grounding 656
E3608 Grounding Electrode System 656
E3609 Bonding 658
E3610 Grounding Electrode Conductors 659
E3611 Grounding Electrode Conductor
Connection to the Grounding Electrodes 659

CHAPTER 37 BRANCH CIRCUIT AND FEEDER REQUIREMENTS 661

Section
E3701 General 661
E3702 Branch Circuit Ratings 661
E3703 Required Branch Circuits 662
E3704 Feeder Requirements 663
E3705 Conductor Sizing and Overcurrent
Protection 664
E3706 Panelboards 667

CHAPTER 38 WIRING METHODS 669

Section
E3801 General Requirements 669
E3802 Above-ground Installation Requirements 669
E3803 Underground Installation Requirements 671

CHAPTER 39 POWER AND LIGHTING DISTRIBUTION 675

Section
E3901 Receptacle Outlets 675
E3902 Ground-fault and Arc-fault
Circuit-interrupter Protection 677
E3903 Lighting Outlets 679
E3904 General Installation Requirements 679
E3905 Boxes, Conduit Bodies and Fittings 691

E3906 Installation of Boxes, Conduit
Bodies and Fittings 694
E3907 Cabinets and Panelboards 696
E3908 Grounding 697
E3909 Flexible Cords 701

CHAPTER 40 DEVICES AND LUMINAIRES 703

Section
E4001 Switches 703
E4002 Receptacles 704
E4003 Luminaires 705
E4004 Luminaire Installation 707
E4005 Track Lighting 708

CHAPTER 41 APPLIANCE INSTALLATION 709

Section
E4101 General 709

CHAPTER 42 SWIMMING POOLS [ELECTRICAL PROVISIONS] 713

Section
E4201 General 713
E4202 Wiring Methods for Pools, Spas, Hot Tubs and
Hydromassage Bathtubs 713
E4203 Equipment Location and Clearances 715
E4204 Bonding 717
E4205 Grounding 719
E4206 Equipment Installation 720
E4207 Storable Swimming Pools,
Storable Spas, and Storable Hot Tubs 722
E4208 Spas and Hot Tubs 723
E4209 Hydromassage Bathtubs 723

CHAPTER 43 CLASS 2 REMOTE-CONTROL, SIGNALING AND POWER-LIMITED CIRCUITS 725

Section
E4301 General 725
E4302 Power Sources 725
E4303 Wiring Methods 725
E4304 Installation Requirements 726

CHAPTER 44 HIGH-VELOCITY HURRICANE ZONES 727

Section
4401 High-Velocity Hurricane Zones—Exterior Wall
Covering 727

4402	High-Velocity Hurricane Zones—Roof Assemblies and Rooftop Structures	727	APPENDIX E FLORIDA STANDARD FOR MITIGATION OF RADON IN EXISTING BUILDINGS	797
4403	High-Velocity Hurricane Zones—General.	727		
4404	High-Velocity Hurricane Zones—Foundations and Retaining Walls	727	APPENDIX F FLORIDA STANDARD FOR PASSIVE RADON-RESISTANT NEW RESIDENTIAL BUILDING CONSTRUCTION	805
4405	High-Velocity Hurricane Zones—Concrete.	727		
4406	High-Velocity Hurricane Zones—Light Metal Alloys	727	APPENDIX G PIPING STANDARDS FOR VARIOUS APPLICATIONS.	811
4407	High-Velocity Hurricane Zones—Masonry.	727		
4408	High-Velocity Hurricane Zones—Steel	727	APPENDIX H PATIO COVERS	815
4409	High-Velocity Hurricane Zones—Wood	727	Section	
4410	High-Velocity Hurricane Zones—Glass and Glazing	727	AH101 General.	815
4411	High-Velocity Hurricane Zones—Gypsum Board and Plaster	727	AH102 Definition.	815
4412	High-Velocity Hurricane Zones—Plastics.	727	AH103 Exterior Walls and Openings.	815
	CHAPTER 45 PRIVATE SWIMMING POOLS.	729	AH104 Height.	815
	Section		AH105 Structural Provisions	815
	E4501 General	729	AH106 Special Provisions for Aluminum Screen Enclosures in Hurricane-prone Regions	815
	Part IX—Referenced Standards	737		
	CHAPTER 46 REFERENCED STANDARDS	737	APPENDIX I PRIVATE SEWAGE DISPOSAL	819
	APPENDIX A SIZING AND CAPACITIES OF GAS PIPING	767	Section	
	APPENDIX B SIZING OF VENTING SYSTEMS SERVING APPLIANCES EQUIPPED WITH DRAFT HOODS, CATEGORY I APPLIANCES, AND APPLIANCES LISTED FOR USE WITH TYPE B VENTS	779	AI101 General.	819
	APPENDIX C EXIT TERMINALS OF MECHANICAL DRAFT AND DIRECT-VENT VENTING SYSTEMS	789	APPENDIX J EXISTING BUILDINGS AND STRUCTURES	821
	APPENDIX D RECOMMENDED PROCEDURE FOR SAFETY INSPECTION OF AN EXISTING APPLIANCE INSTALLATION	791	Section	
			AJ101 Purpose and Intent	821
			AJ102 Compliance	821
			AJ103 Preliminary Meeting	822
			AJ104 Evaluation of an Existing Building	822
			AJ105 Permit.	822
			AJ201 Definitions	822
			AJ301 Repairs	823
			AJ401 Renovations	823
			AJ501 Alterations	823
			AJ601 Reconstruction	824
			APPENDIX K SOUND TRANSMISSION.	827
			Section	
			AK101 General.	827
			AK102 Air-borne Sound.	827

TABLE OF CONTENTS

AK103 Structural-borne Sound 827
 AK104 Referenced Standards 827

APPENDIX L PERMIT FEES 829

APPENDIX M HOME DAY CARE—R-3 OCCUPANCY 831

Section
 AM101 General 831
 AM102 Definition 831
 AM103 Means of Egress 831
 AM104 Smoke Detection 832

APPENDIX N VENTING METHODS 833

APPENDIX O AUTOMATIC VEHICULAR GATES 839

Section
 AO101 General 839
 AO102 Definition 839
 AO103 Automatic Vehicular Gates 839

APPENDIX P SIZING OF WATER PIPING SYSTEM 841

Section
 AP101 General 841
 AP102 Information Required 841
 AP103 Selection of Pipe Size 841
 AP201 Selection of Pipe Size 858

APPENDIX Q RESERVED 861

APPENDIX R LIGHT STRAW-CLAY CONSTRUCTION 863

Section
 AR101 General 863
 AR102 Definitions 863
 AR103 Nonbearing Light Straw-Clay Construction 863

AR104 Thermal Insulation 864
 AR105 Referenced Standard 864

APPENDIX S STRAWBALE CONSTRUCTION 865

Section
 AS101 General 865
 AS102 Definitions 865
 AS103 Bales 865
 AS104 Finishes 866
 AS105 Strawbale Walls—General 867
 AS106 Strawbale Walls—Structural 869
 AS107 Fire Resistance 872
 AS108 Thermal Insulation 873
 AS109 Referenced Standards 873

APPENDIX T RECOMMENDED PROCEDURE FOR WORST-CASE TESTING OF ATMOSPHERIC VENTING SYSTEMS UNDER N1102.4 OR N1105 CONDITIONS $\leq 5ACH_{50}$ 875

Section
 T101 Scope 875
 T202 General Definitions 875
 T301 Testing Procedure 875

APPENDIX U SOLAR-READY PROVISIONS—DETACHED ONE- AND TWO-FAMILY DWELLINGS, MULTIPLE SINGLE-FAMILY DWELLINGS (TOWNHOUSES) 877

Section
 U101 Scope 877
 U102 General Definition 877
 U103 Solar-ready Zone 877

INDEX 879